

HALSTON ST.

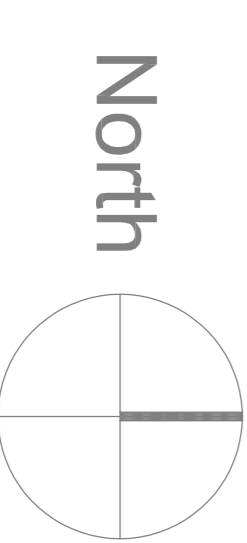

North

1A

2A

1A

2A

OUTLINE OF EX. BASEMENT

EXTENT OF EX. BASEMENT

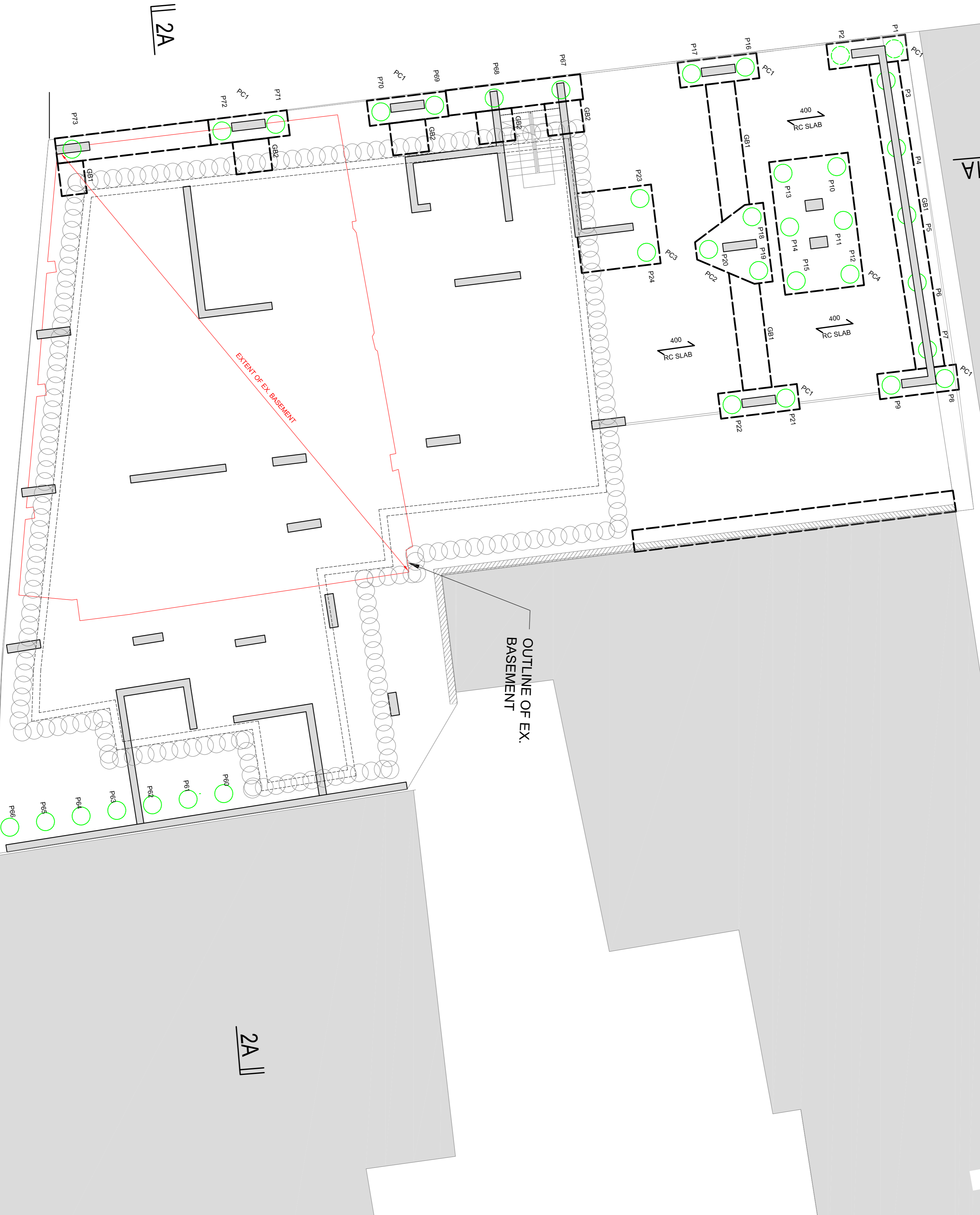

MARYS LN.
BLOCK A
GROUND FLOOR
SCALE 1:100

GB1	1200 W x 1800 dp GROUND BEAM
GB2	1500 W x 1800 dp GROUND BEAM
PC1	3300 x 1050 x 1800 dp 2No. PILE CAP
PC2	3300 x 3010 x 1800 dp 3No. PILE CAP
PC3	3300 x 3300 x 1800 dp 4No. PILE CAP
PC4	5500 x 3300 x 1800 dp 6No. PILE CAP

TITLE GREEN ST.

LEGEND:

- : 900 PILE AT BASEMENT LEVEL
34 No. AT BASEMENT LEVEL
- : 750 PILE AT GROUND LEVEL
34 No. AT GROUND LEVEL
- : 750 SECANT PILE WALL

PILING AREA:

BLOCK A:
34 No. 750Ø AREA=15,02m²
34 No. 900Ø TOTAL AREA=24,1m²
750 SECANT PILE WALL AREA=74,5m²
TOTAL AREA= 927,5m²
PILED AREA=24,1m² + 15,02m² + 74,5m²=113,5m²
%AREA=113,5m²/927,5m²=12,2%

REV	Date	By	Description
P1	04/03/2020	MG	Issued for Final Planning
0	08/03/2020	MG	Issued for Planning

LOHAN & DONNELLY
Consulting Engineers

13 Gardiner Place, Moynagh Square, Dublin 1. T: 01 5787770
W: www.lohan-donnelly.com E: info@lohan-donnelly.com

Job: Development of Market Lands for The Fruitmarket Partnership

Block A Ground Floor Plans & Details

Job No.	19143	Proj. No.	A100
Scale	@A1	Date	FEB/20
Drawn	MG	Rev.	P1